

Aquatrol Inc. is the owner of this print and design thereon

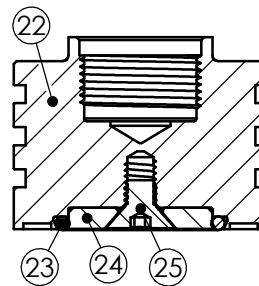
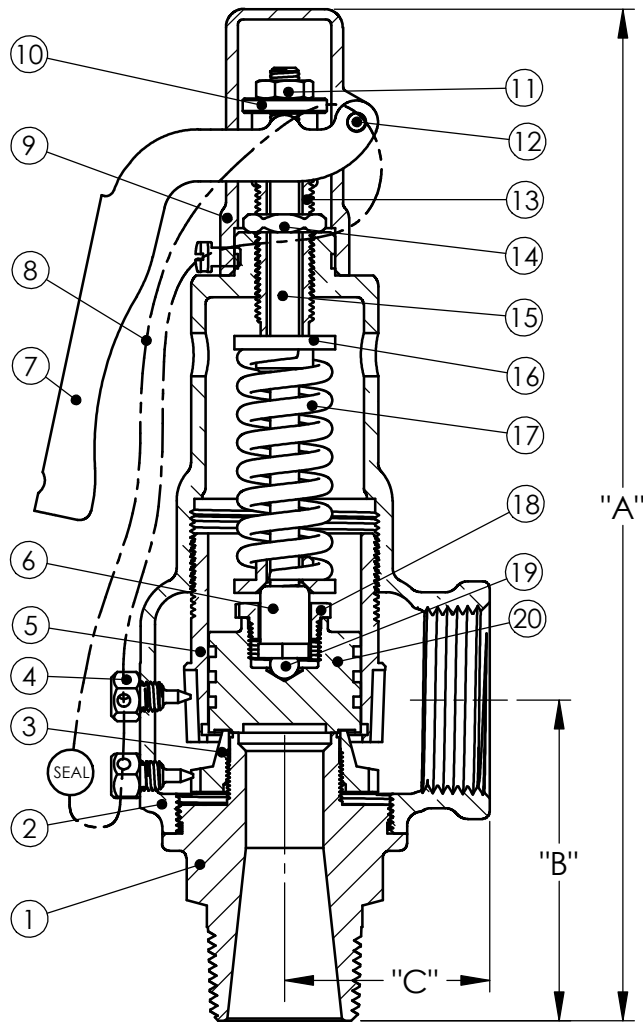

Soft Seat Option

Series 560 ASME - NB Section I Steam  
Series 570 ASME - NB Section VIII Air/Gas/Steam

Inlet Sizes from 1/2" to 2 1/2"  
560/570 Max. 300 P.S.I. Air, 250 P.S.I. Steam, Max. Temp 406°F  
563/573 Max. 300 P.S.I. Air, 300 P.S.I. Steam, Max. Temp 425°F

| ITEM | DESC.          | MODEL / MATERIAL   |                    |
|------|----------------|--------------------|--------------------|
|      |                | 560 / 570          | 563 / 573          |
| 1    | Body           | B16/B62 C83600     | A479-316 SS        |
| 2    | Bonnet         | B584 C84400        | B584 C84400        |
| 3    | Lower Ring     | B584 C84400        | B584 C84400        |
| 4    | Lock Screw     | B16 Brass          | B16 Brass          |
| 5    | Upper Ring     | B584 C84400        | B584 C84400        |
| 6    | Spring Support | B16 Brass          | B16 Brass          |
| 7    | Lift Lever     | Steel / Plated     | Steel / Plated     |
| 8    | Seal Wire      | Steel / Galvanized | Steel / Galvanized |
| 9    | Hood           | Aluminum / Plated  | Aluminum / Plated  |
| 10   | Lifter Nut     | B16 Brass          | B16 Brass          |
| 11   | Jam Nut        | 18-8 SS            | 18-8 SS            |
| 12   | Lever Pin      | B16 Brass          | B16 Brass          |
| 13   | Pressure Screw | B16 Brass          | B16 Brass          |
| 14   | Lock Nut       | B16 Brass          | B16 Brass          |
| 15   | Stem           | B16 Brass          | B16 Brass          |
| 16   | Spring Plate   | B16 Brass          | B16 Brass          |
| 17   | Spring         | Stainless          | Stainless          |
| 18   | Disc Nut       | B16 Brass          | B16 Brass          |
| 19   | Ball Bearing   | 440 SS             | 440 SS             |
| 20   | Disc           | B16 Brass          | A479-316 SS        |
| 21   | Name Plate     | Stainless          | Stainless          |
| 22   | Disc           | B16 Brass          | A479-316 SS        |
| 23   | O-Ring         | Various            | Various            |
| 24   | Center Insert  | B16 Brass          | A479-316 SS        |
| 25   | Screw          | 18-8 SS            | 18-8 SS            |

| Inlet x Outlet  | Orifice | "A"     | "B"    | "C"    |
|-----------------|---------|---------|--------|--------|
| 1/2" x 3/4"     | "D"     | 7-1/4"  | 2-3/8" | 1-1/2" |
| 3/4" x 3/4"     | "D"     | 7-1/4"  | 2-3/8" | 1-1/2" |
| 3/4" x 1"       | "E"     | 7-5/8"  | 2-1/2" | 1-5/8" |
| 1" x 1"         | "E"     | 7-5/8"  | 2-1/2" | 1-5/8" |
| 1" x 1-1/4"     | "F"     | 8-7/8"  | 2-3/4" | 1-3/4" |
| 1-1/4" x 1-1/4" | "F"     | 8-7/8"  | 2-3/4" | 1-3/4" |
| 1-1/4" x 1-1/2" | "G"     | 9-1/2"  | 3-3/8" | 2-1/4" |
| 1-1/2" x 1-1/2" | "G"     | 9-1/2"  | 3-3/8" | 2-1/4" |
| 1-1/2" x 2"     | "H"     | 11"     | 3-5/8" | 2-5/8" |
| 2" x 2"         | "H"     | 11"     | 3-5/8" | 2-5/8" |
| 2" x 2-1/2"     | "J"     | 12-5/8" | 4"     | 3-1/8" |
| 2-1/2" x 2-1/2" | "J"     | 12-5/8" | 4"     | 3-1/8" |



|              |           |                              |
|--------------|-----------|------------------------------|
| PART NAME    |           | Series 560/570               |
| Date:        | 7/13/2014 | Part Number<br><b>560609</b> |
| Drawn by:    |           |                              |
| Approved by: |           |                              |

Revised 10/09/2020