

Aquatrol Inc. is the owner of this print and design thereon

Series 140A - 140B
 ASME - NB Section VIII Air/Gas
 Max Temp: 800°F (Series 140/141 406°F)

Item	Description	Series 140	Series 141	Series 143
1	Body	B16 Brass	SA479-316, SS	SA479-316 SS
2	Disk	Stainless	Stainless	Stainless
3	Disk Holder	B16 Brass	B16 Brass	SA479-316 SS
4	Name Plate/Rivet	Stainless	Stainless	Stainless
5	Spring Plate	B16 Brass	B16 Brass	SA479-316 SS
6	Pressure Screw	B16 Brass	B16 Brass	SA479-316 SS
7	Pull Ring	Plated Steel	Plated Steel	Stainless
8	Spring Post	B16 Brass	B16 Brass	SA479-316 SS
9	Hood	B16 Brass	B16 Brass	SA479-316 SS
10	Lock Nut	B16 Brass	B16 Brass	SA479-316 SS
11	Spring	Stainless	Stainless	Stainless
12	Bonnet	B16 Brass	B16 Brass	SA479-316 SS
13	Lift Lever	Plated Steel	Plated Steel	Chrome/Steel
14	Lever Pin	B16 Brass	B16 Brass	Chrome/Brass
15	Seal Wire	Steel / Lead	Steel / Lead	Stainless / Lead

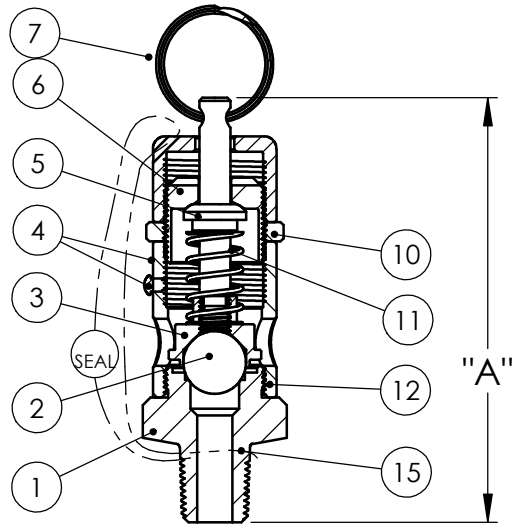

140A with Pull Ring

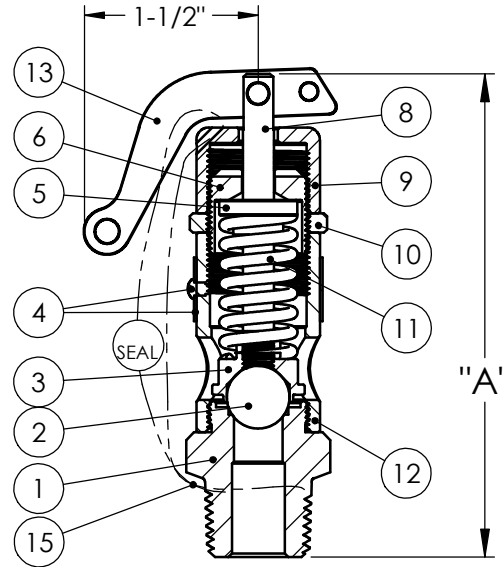

140B with Lift Lever

Orifice	Slope	Inlet	"A" Dimension		Max. P.S.I.
			Pull Ring	Lift Lever	
A	.924	1/4"	3-3/8"	3-1/2"	450
		3/8"	3-3/8"	3-1/2"	
		1/2"	3-3/8"	3-1/2"	
B	1.487	3/8"	3-3/4"	3-7/8"	
		1/2"	3-3/4"	3-7/8"	
		3/4"	3-3/4"	3-7/8"	

Series 140 limited to 350 P.S.I.

Aquatrol
 VALVE COMPANY, INC.

PART NAME		Series 140 - 143	
Date:	5/21/2015	Part Number	
Drawn by:		3-140-00	
Approved by:			

Revised: 10/06/2020