

Aquatrol Inc. is the owner of this print and design thereon

Item	Description	Series 140	Series 141	Series 143
1	Body	B16 Brass	SA479-316, SS	SA479-316, SS
2	Disk	Stainless	Stainless	Stainless
3	Disk Holder	B16 Brass	B16 Brass	SA479-316, SS
4	Name Plate	Stainless	Stainless	Stainless
5	Spring Plate	B16 Brass	B16 Brass	SA479-316, SS
6	Pressure Screw	B16 Brass	B16 Brass	SA479-316, SS
7	Pull Ring	Plated Steel	Plated Steel	Plated Steel
8	Spring Post	B16 Brass	B16 Brass	SA479-316, SS
9	Hood	B16 Brass	B16 Brass	SA479-316, SS
10	Lock Nut	B16 Brass	B16 Brass	SA479-316, SS
11	Spring	Stainless	Stainless	Stainless
12	Bonnet	B16 Brass	B16 Brass	SA479-316, SS
13	Lift Lever	Plated Steel	Plated Steel	N/A
14	Lever Pin	B16	B16	N/A
15	Seal Wire	Steel / Lead	Steel / Lead	Stainless / Lead

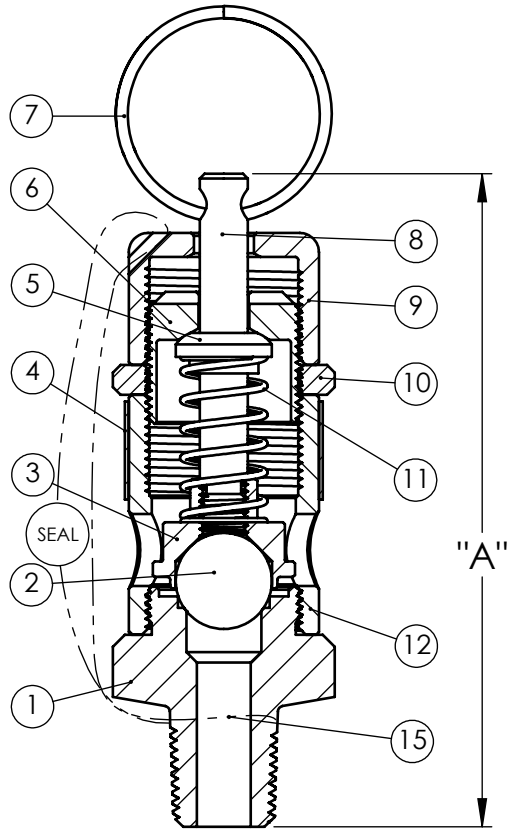

Pull Ring

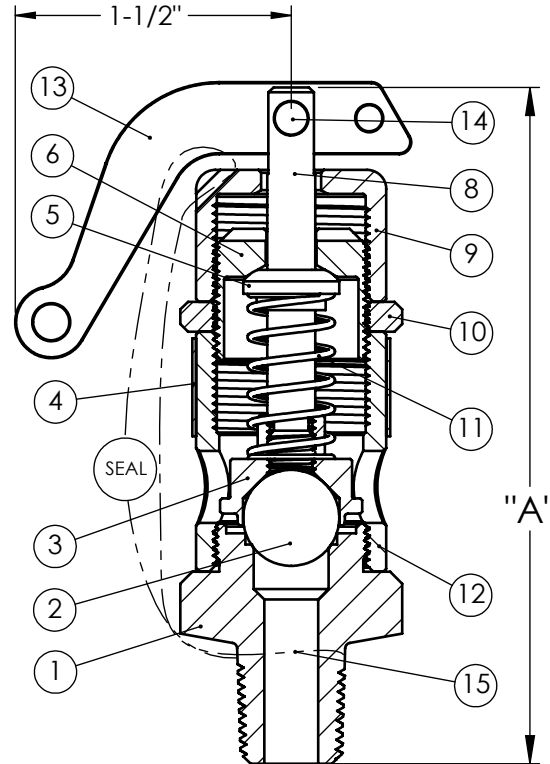

Lift Lever

Orifice	Area	Inlet	"A" Dimension		Max. P.S.I.
			Pull Ring	Lift Lever	
A	.062 Sq. In.	1/4"	3-3/8"	3-9/16"	450
		3/8"	3-3/8"	3-9/16"	
		1/2"	3-3/8"	3-9/16"	
B	.119 Sq. In.	3/8"	3-3/4"	3-15/16"	
		1/2"	3-3/4"	3-15/16"	
		3/4"	3-3/4"	3-15/16"	

**Aquatrol**  
VALVE COMPANY, INC.

PART NAME		Series 140 - 143
Date:	5/21/2015	Part Number <b>3-140-00</b>
Drawn by:		
Approved by:		

Revised: 8/10/2018